

# Cornered Ci2



## FEATURES

2 1/2" woofer  
 3/4" dome tweeter  
 Triangular ABS cabinet  
 IP54 rated  
 Mounts without brackets  
 Hidden cable connection

## COLOURS



## Description

Ci2 is an ultra compact 2-way full-range speaker with a full-bodied sound. Featuring a tweeter with highly uniform dispersion, coverage is very wide and as such the speaker does not need to be angled, but will cover the entire room with sound while placed in the corner. The waveguide of the tweeter contributes to the very controlled dispersion and increases sensitivity. The cabinet design is exceptionally discreet while offering natural, clean sound.

With the patented triangular Cornered design, installation is fast and easy. The integrated mounting points allows the cabinet to mount flush in corners or onto walls and ceilings without brackets. Two cabinets can be mounted together to increase coverage to 180 degrees. The cable terminal is hidden behind the grille with the cable mounted from the rear of the cabinet, making cables invisible both in vertical and horizontal applications.

Ci2 plays well beyond its size and is very well suited for background sound in coffee shops, hotels and retail outlets.

## DATA

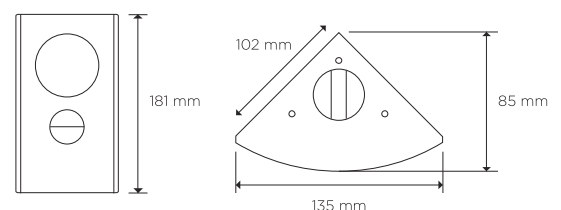

Power handling, IEC268:	30 watt
Power handling, peak:	120 watt
Sensitivity, 2.83V/1m:	84 dB
Maximum SPL, long term:	99 dB
Maximum SPL, peak:	105 dB
Frequency response:	140-20.000 Hz
Nominal impedance:	8 ohm
Dispersion:	100x100 degrees
Measurements:	(HxWxD) 181x135x102mm
Weight:	0,75 kg

# Cornered Ci2

## Architectural Specifications

The loudspeaker system shall consist of a 2 ½" woofer and a ¾" tweeter coupled to a wave guide with an even dispersion of nominal 100° by 100° degree.

Specifications of a typical production shall be as follows: SPL at 1 m with 2.83 V input shall be at least 84 dB. Nominal impedance shall be 8 ohms, with minimum impedance being 8 ohm @15 kHz. Rated power handling according to IEC 268-5 shall be at least 30 watt. Frequency response shall be from 140-20kHz +/- 3 dB.

The enclosure shall be triangular in shape with no visible cable terminals and with a 90 degree angle allowing the speaker to be mounted flush in corners or onto wall and ceiling without brackets using the integrated mounting points. It shall be manufactured of ABS plastic with EN54 fire-proof certification and IP54 outdoor rating. For theft deterrence, the installation points shall be hidden behind the grille. Speaker cable terminals shall be push terminals placed on the front baffle.

Cabinet finish shall be white or black. Outside dimensions shall be no greater than 181mm (height) x 135mm (width) x 102mm (depth) and weight shall be 0,75 kg. The loudspeaker system shall be the Cornered Audio Ci2.

### FREQUENCY RESPONSE

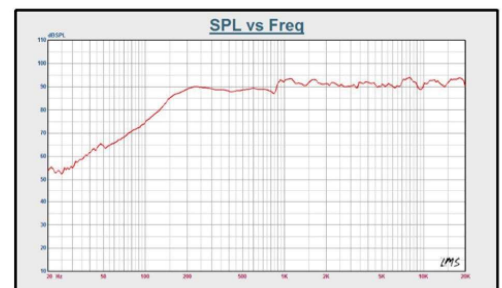

### IMPEDANCE

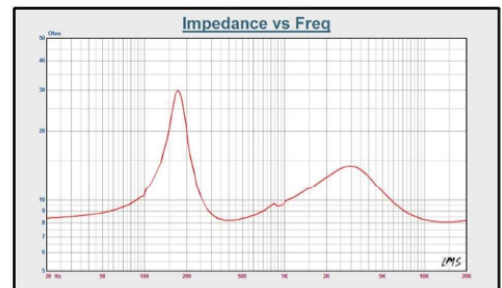

CORNERED Audio ApS  
Rosenkæret 13, 2. th.  
2860 Søborg  
Denmark

Mail [info@cornered.dk](mailto:info@cornered.dk)  
Tel +45 43 66 10 88  
Web [www.cornered.dk](http://www.cornered.dk)